

Multifunctional Instrument

INSTRUCTION



Dear customer,
Thanks for your choosing our product!
For the best capability and safety, please read the instruction before operation.
Please reserve the instruction book for the reference.

●Panel introduction

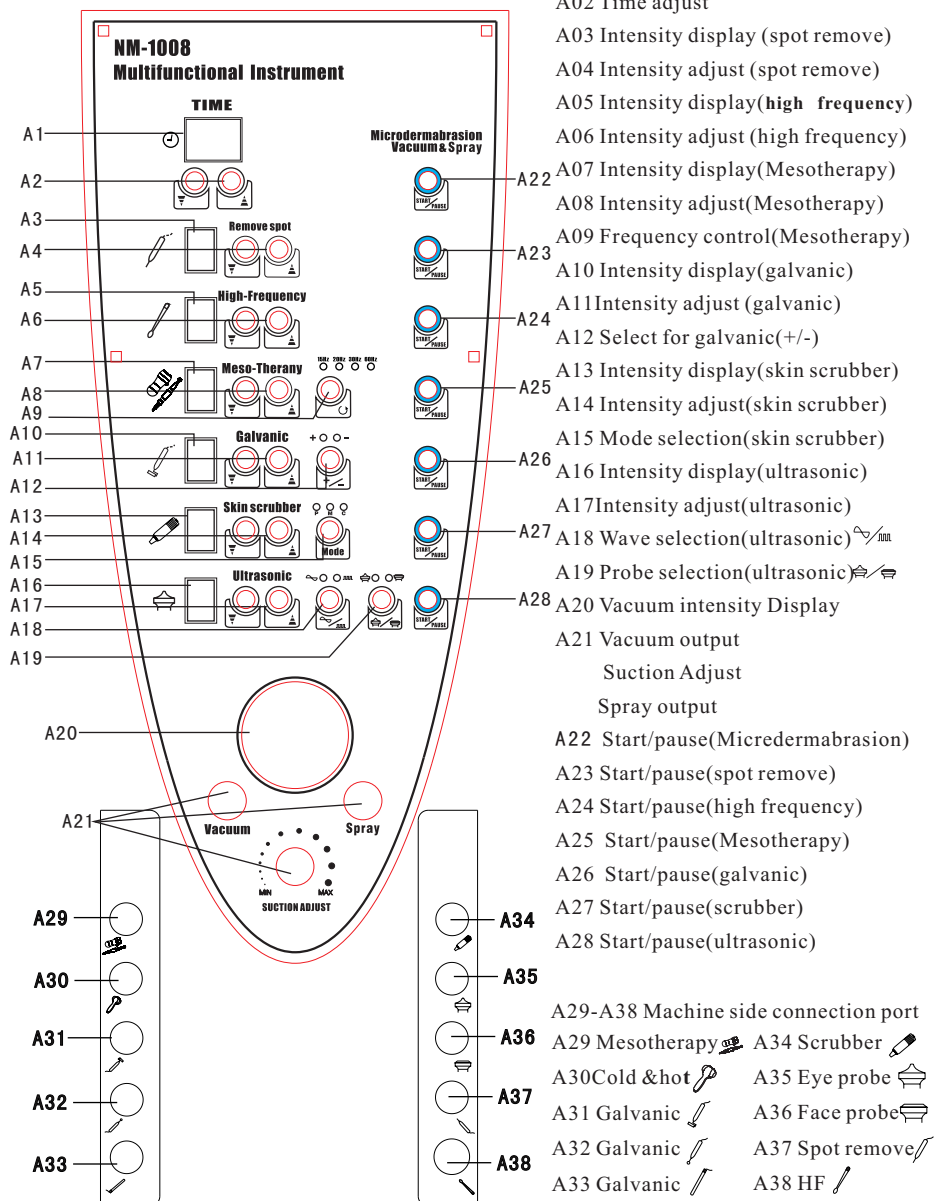

● High frequency electrotherapy

I . Principle of high frequency

High frequency function is made up from high frequency electrical board, capacitances and semiconductors. The accessory include high frequency probe and glass tube. There is a transformer in the high frequency probe for voltage rising. In one side of the high frequency probe, there is a electrical wire, when connect it to the instrument and start the instrument, because of the working of high frequency electrical board, there is generated intermittent current, which is high voltage and high frequency. This kind of high frequency current can make glass electrode discharge. Inside the glass electrode, there is full of helium gas and neon gas, which can generate blue or pink light and coming with a sound like cheep. The light can make blood vessel expand and shrink, ionize the oxygen to ozone , in this way to improve blood circulation, get the effectiveness of sterilization and diminish inflammation.

II. Function of high frequency

1. Accelerate the blood circulation, strengthen lymph action, supply nutrition to skin, get ride of toxic substance.
2. Strengthen metabolism of cell , help skin breath and excrete.
3. Bring heat to skin fibre, improve skin condition, help nutrition go into the kin
4. To sterilize and diminish inflammation, promote the wound to heal up, and strengthen skin immunity.

III. Operation step and method

1. Indirect electrotherapeutics

- (1) After sterilization, put the glass tube into the high frequency probe, screw it to tight.



● High frequency electrotherapy

- (2) Client put talcum powder on the hand then hold the glass tube, start the instrument and let the current go through body by hand.
- (3) Beautician make massage to client, from neck to chin, to Cheek, to forehead.
- (4) Adjust current intensity to zero, power off the instrument and screw out glass tube.

This method can stimulate fibre tissue, keep and recover the elasticity of skin. It is special good for shrivel skin and effete skin.

2. Direct electrotherapeutics

- (1) Spread nutrition liquid or face cream on the skin, beautician hold the probe, put glass tube on the forehead, start the instrument.
- (2) Use the glass tube to massage face in a helix or "z" way, the process order is forehead->nosebridge-> nosewing->right cheek->chin->left cheek->nosewing->nosebridge->forehead.
- (3) Adjust the current intensity to zero, power off the instrument, screw out glass tube.

This method can make nutrition completely go into the skin, dissolve skin fat. It is special good for oily skin.

● High frequency electrotherapy

3. Spark electrotherapy



- (1) Use sterilized cotton patch to cover client's eyes, beautician hold high frequency probe, start the instrument, adjust current intensity, dot the inflamed part, the treatment time should not be more than 10 seconds.
- (2) when glass tube touch the skin, there is spark. It is normal when your skin get the feeling of acmesthesia.
- (3) Adjust the electrical current intensity to zero, power off the instrument, screw out glass tube.

This method can make strong effectiveness of sterilization, accelerate to heal up the wound. It is good to cure tumefaction, inflammation and injured skin.

IV. Tips and taboo

1. When make treatment to the tender skin with the method of spark electrotherapy, should use a thin voile to cover the skin, let electrical current penetrate to the skin through voile, in this way can reduce the stimulation to skin from electrical current.
2. It is forbidden to make treatment to the people who is pregnant or there is metal inside the body.
3. Before operation, please put in the glass tube first then start the machine, the electrical current be adjusted from weak to strong. If finish the operation, the electrical current should adjust to zero.
4. Before operation, should use wet cotton clothes cover the eyes of client or ask client to close eyes. When make spark electrotherapy, the treatment time should not continuously more than 10 seconds for a part.
5. The treatment should not apply to fleck and splash of the skin.

● Ultrasonic

Theory of ultrasonic

Ultrasonic beauty technology introduced to the beauty field from 80s and become popular as its wide care range and rapid effect as well as high healing ratio and simply operation, also become the most popular and practical instrument in beauty field. With the development of science technology, the new era of professional ultrasonic beauty instrument launched in market. Popularised by all the customers as its brilliant quality、multifunction、and deluxe appearance.

1. Mechanical function: Using 300 million time per second mechanical vibration to make the whole body vibrate and do the special cell massage function, also improve cell metabolism and blood circulation as well as activate cell and keep skin tissue nutrient, thus to make the skin shine and stretchy.
2. Warming function: Ultrasonic heating function by means of changing blood vessel function and metabolism procedure, riches blood circulation and slow down the cell excited point, help to relief pain. Also it could loosen the nerve muscle and resist muscular nerve.
3. Chemical function: Ultrasonic wave could do stimulating effect and speed up metabolism. Also it could make the pH value change into alkaline trend and do good for drug penetration as well as improve the drug sterilize ability.

● Ultrasonic

Function of Ultrasonic

1. Soften thrombus and remove red eruption; Rectifying distorted capillary by using supersonic pulse signal together With some suitable ointment, thus to remove red eruption.
2. Remove scar or scab: Supersonic not only decomposed dry blood of the skin, but also improves the metabolism and blood circulation, thus to remove the marks and scar. It is better to use supersonic together with some suitable ointment, normally 10 times as a period treatment and every two days one time.
3. Eliminate abnormal skin pigment: Using supersonic together with some Chinese traditional medicine facial cream 、 speck cream or high unit vitamin C, could do beneficiary effect to remove pigment. It does effect by 3 times treatment and thoroughly eliminate by 10 to 40 times treatment.
4. Eliminate hypodermic speck and pigment: Using supersonic to damage the cell membrane of the speck and protect it forming shape, thus to eliminate pigment and remove the speck thoroughly together with metabolism function. 10 times as a period treatment and take a break for one week before another treatment.
5. Remove slight wrinkles and gore as well as lifting skin: By using the mechanism massage function of supersonic, one side it regulates the changing of the membrane of the hypodermic cell, on the other hand it improves blood circulation and metabolism. Thus to remove slight wrinkles as well as gore or scar which caused by hard substance.

● Ultrasonic

6. Remove eye bags and eye circle: By using the mechanism massage function of the supersonic to accelerate the blood and lymph circulation, together with the warming function to decompose fat and improve the hypodermic absorption, thus to decrease the excessive water and piled fat and finally eliminate eye circles and eye bags thoroughly. Massaging the eye bags tenderly in the same direction of skin texture with the probe. Do not touch the eyeball directly with the probe or operate on the upper eyes.
7. Cure tumefaction or scar: Using supersonic together with some ointment to massage the sicken part for nearly one minute, thus to avoid forming scar while the tumefaction healed.
8. Cure sclerosis and rough skin: Using supersonic together with glycerin、liquid wax or advanced lubricant to do massage, thus to improve the effect of the treatment.
9. Improve the skin nature: Remove speck and improve the skin condition by means of super

Taboo:

1. The people with osteoporosis can not use this instrument.
2. The skin with problems can not use this instrument such as decomposed
3. The people with mental illness can not use this instrument.
4. During the operation the probe can not be faced eyeball.
5. The pregnant woman can not do the operation of breast leg and belly.
6. The people with false body parts can not use this instrument on this part.
7. The people with offal problems can not use it on belly and breast.

● Ultrasonic

OPERATION PROCEDURES:

1. Big probe for face, continuous wave, for 15 minutes.
2. Small probe for eyes, pulse wave, 5 minutes for each.
3. Duration, intensity and wave type should all depend on skin nature.
 - a. Extra dry skin: mature, spot and aged skin
Duration: 13-15 mins; Intensity: 3-5 ; Wave: Continuous
 - b. Dry skin: Thinner, red capillary skin
Duration: 10-12 mins; Intensity: 3-4 ; Wave: Continuous
 - c. Normal skin: Healthy skin
 - d. Oily skin
Duration: 8 mins; Intensity: 3-5 ; Wave: Continuous
 - e. Acne skin
Duration: 8-10 mins; Intensity: 3-4 ; Wave: Pulse
 - f. Sensitive skin
Duration: 6-8 mins; Intensity: 2-3; Wave: Pulse
 - g. Eye (each)
Duration: 4-5 mins; Intensity: 1-3 ; Wave: Pulse

The probe should be moved spirally.
(Forehead, left face, right face,
Chin 2 minutes respectively)



Notice:

1. Before the operation the operator must clean the clients' face and smear enough cream.
2. the operation should be within 15 minutes and adjust the intensity according to the nature of the skin.
3. when the instrument is used on sensitive skin the intensity should be lower. 10 times become a treatment and the time is one week.

● High frequency spot remove

The High Frequency Spot Remover is through the high frequency electricity rate coagulation, urges the epidermal cell necrosis, which can in instantaneous thoroughly eliminate all kinds of spot both on the face and on skin surface, such as old age spots, freckles, granules, tattoos, moles, etc. The effect is obvious with no bleeding or scar left.

Operation Procedures:

1. Sterilize the devises with 75% alcohol.
2. Plug in the power supply, and plug the spot remover into relevant slot.
3. Switch on the power, and adjust the intensity to suitable degree.
4. Grasp the spot remover and carefully point on the spotted mole, until seeing Melanin excreted as waste.
5. Apply medicine for disinfections on the surface.
6. Please grease antiphlogistin after the treatment.

Cautions:

1. Before using, the spot remover and the surface should be cleaned and sterilized.
2. After every usage, remove the power supply, and the spot remover for cleaning and sterilizing.
3. When using, do not stab in, and only for recommended duration to avoid burns on the dermis.
4. If spot are not to remover during one usage, do not use again until the scab falls off.
5. Removing no more than 5 spots is recommended in one usage.
6. After the usage, it is recommended the client not to wet the operated surface within 22 hours, do not eat ginger and anything with dark color.
7. Do not tear away the scab, must let it fall off to avoid infections and scars.
8. Do not expose intensely under the sunshine.

● Diamond Microdermabrasion

I. Working principle

Microdermabrasion exfoliate the top layer of the skin by using genuine diamond crystals at the tip to gently sand the skin while simultaneously sloughing off the dead skin cells in a sterile and controlled manner. Unlike the traditional microdermabrasion, Diamond Head does not use loose crystals or other abrasives that may cause irritation and skin reaction. Rather, this innovative device offers hypoallergenic treatment using diamond crystals to perform a customized exfoliation treatment for each area of your skin. After just one treatment you will already begin to experience softer, smoother, cleaner skin.

When used regularly, this system works wonderfully on all skin types can be used on the face, neck, decollate or the entire body for a youthful, polished appearance. You will notice immediate visible results.

II. Accessory and assembling

■ Accessory picture

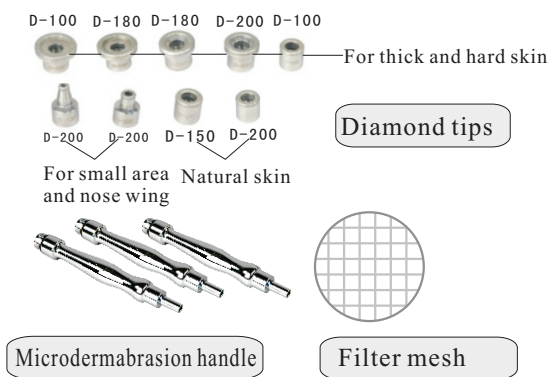

■ Assembling picture

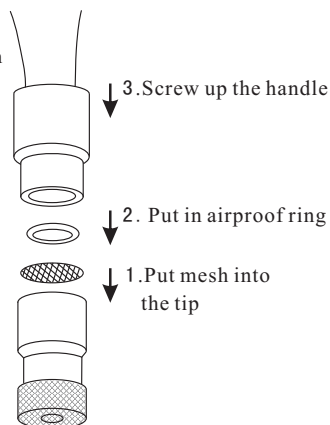

● Diamond Microdermabrasion

III. Operation procedure

1. Connect the microdermabrasion handle with the output port.
2. Choose a proper diamond tip, and put the filter mesh into the diamond tip, and screw it to the handle.

Attention:

- A) During operation, if the suction is not strong enough, please replace a new filter mesh.

According to the different skin type and the skin area, it needs different quantity of filter mesh. At every operation, it needs to refill the filter mesh.

- B) There are big and small diamond tips, first use big tips for hard and thick skin, then use small tips .

3. When adjust suction, the thinner skin and the smaller suction use. Such as for eye pouch and crow's feet, the suction should be adjusted to the smallest one.

4. Before operation, please first try it on hands, and when operation use fingers to spread the skin in order to make the skin area get the same strength of suction. Separate the face area to left and right, up and down, move or roll the diamond heads like the instruction of the picture. The diamond heads should not stay at a point of skin more than 15 seconds.

5. After the operation, should use brush with water to clean diamond heads, after the cleaning, put it into the solution consist of 75% alcohol for 15 minutes, then take it out and wipe it to complete dry. Put it into the ultraviolet radiation sterilizer for next using.

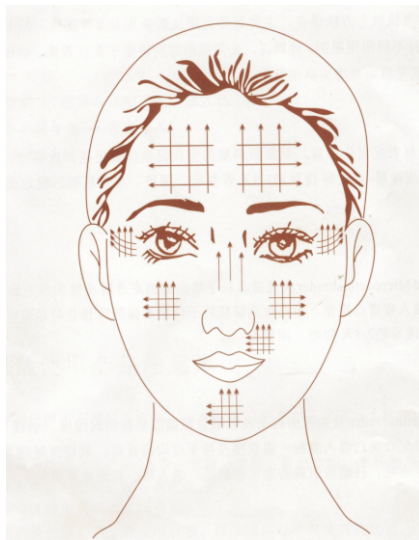

● Galvanic

Galvanic enhances the ability of active molecules to penetrate the skin surface. Its benefits are wide and far-reaching: it increases the skin's absorption capacity, it minimizes wrinkles and it normalizes skin.

Electronegative & positive charge and hydronium are in use of a kind of concatenation & safety to conducting in & out.

Deep penetration of active substances with special appliance for iontophoresis and desincrustation.

Operation procedures:

1. Plug the power wire, idler wheel, and metal stick separately. Beautician holds the idler wheel and client clasp the metal stick.
2. Adjust the button of intensity.
3. Choose the cathode and anode according to the clients' need. When the button refers to +, then idler wheel is positive, metal stick is negative. At this time the operator can smear some cream on the skin. When the button refers to -, the idler wheel is negative and the metal stick is positive. The operator can use a mass cotton paper disinfected with distilled water and bundle with idler wheel. Gently touch the clients' face with idler wheel. Conducting in&out can deeply clean clients' skin and remove oil, residues with good effect.
4. After the operation turn off and disinfect.

Notice:

1. The skin which is allergy, injured can not use this.
2. The people with heart disease and pregnant women should not be applied treatment.
3. The cotton should be wet.
4. Before the operation the instrument should be cleaned.
5. The instrument should be put in the dry place.
6. Before the operation, the operator and the client should remove the metal.
7. Choose the appropriate cream.

● Brief Introduction for Mesotherapy

Needle-free injection is high-effect, woundless and safe treatment, completely removes the traditional meddle and microneedle injection. It uses the electroporation and electroosmosis, to supply nutrition to the deep-seated cells, lymph drainage, promote metabolism, lymph and blood circulation, so as to decrease wrinkles, whiten skin and keep moisture, improve cellulite, quicken fat dissolving and weight loss. Comparing it with the single skin care products, effectively absorb products much higher, throughly solve the problems of products only staying at epidermis, shorten the period of treatment.

Work Theory

It uses Electroporation and Electroosmosis techniques, without any injectors, easily opens the aquaporin (AQP), transports skin wanted nutrition, so as to treat all kinds of skin problems. Let the nutrition quickly being absorbed and effective, promote skin metabolism, keep skin elastic and fine.

AQP is the main channel of water in and out of the cells.

What is the electroporation and electroosmosis?

Electroporation: Directly act on the skin, instantly enhance skin tissue penetration. Under the function of electroshock, there will be formed holes in the lipid mobilization of cells, at the same time, the hydrophile molecule which have not been absorbed originally can penetrate into cells inner. Once the holes forming, withing several seconds to several minutes, it will keep the opening state according to the lenth of electroshock.

Electroosmosis: Mainly act on the substance molecule which will be dispersed, help it freely to penetrate into skin inner. Same quality electric charges are mutual repulsion, so it can throw positive current onto positive nutrition molecule, push untritin molecule into skin tissues.

● Brief Introduction for Mesotherapy

At the same time, the neutral molecule also will penetrate into skin inner also.

Function:

Freckle removal and skin whitening: Open cells channel woundless, absorb nutrition, participate in cells metabolism, promote cells rebirth.

Fantasy wrinkle removal: The electrode nutrition is directly penetrated the deep-seated skin, start cells rebirth, remove wrinkles of deep skin layer.

Resist the acne: Through the electric nutrition conveyor belt, inject the acne removal distillate into the focus, clear or restrain the acne rebirth, avoid the wound infection.

Moisten and make up water: Inject the water feeding active distillate into the deep-seated skin, supply enough water to the cells, prevent the series of skin problems caused by short of water.

● Ozone hot steamer

Function:

- ⊙ Accelerate blood circulation and support cell water.
- ⊙ Expand pore and deeply clean.
- ⊙ Remove aging horniness and grime.
- ⊙ Diminish inflammation and sterilize wound.
- ⊙ Improve skin metabolism and rejuvenation epidermis cell.

Procedure:

- i. Use measuring cup to fill distilled water in the
higher
affusion gate and make sure the water should be
than the affusion line.
- ii. Connect the wire and check the power.
- iii. Press the red key, after 5 to 6 minutes, the steam will
come out. This is the normal steam; and then press the
green key, the steam together with the ozone will
come out.
- iv. Please cover eyes with wet cloth patch and don't face
the steam directly before it becomes steadily.
- v. Adjust the distances between the spray spout and
client's face according to the nature of the skin. The
steam should come through the face from upside to
underside.
- vi. Please turn off the machine and power when finished.

Time and Distance:

The treatment time and distance between spray spout and client's face should be adjusted according to the nature of skin.

● Ozone hot steamer

- (1). Normal Skin: distance----25cm~30cm; time (ozone steam)---3~5 minutes
- (2). Greasy Skin: distance----20cm~25cm; time (ozone steam)---5~8 minutes
- (3). Sore Skin: distance----20cm~25cm; time (ozone steam)----8~10 minutes
- (4). Dry Skin: distance----30cm~35cm; time (ozone steam)----3 minutes
- (5). Sensitive Skin: distance----35cm; time (normal steam)----5~8 minutes
- (6). Spot Skin: distance----30cm~35cm; time (normal steam)---5~8 minutes
- (7). Telangiectasis Skin: distance----20cm~25cm; time (normal steam)----5~8 minutes

For all the treatment with ozone, the total time should be within 10 to 15 minutes. Please don't do it over 15 minutes.

Attention:

1. Avoid spray directly to the nostril, as it is easy to cause breath problem or uncomfortable feeling.
2. The treatment time should be less than 15 minutes.
3. If spray arm is loose, can firm it as the picture instruction
4. Water cup should be cleaned periodic.
5. When adding water, please turn the power off first.
 - a. When finish, please turn off the power.
 - b. If furring occurs to clog the steam, please pour in some vinegar and keep for about 15 minutes.



● Magnifying lamp

Easy to move and position, the Magnifying Lamp includes a superior refractive magnifier and a built-in illumination system that allows you to examine skin with great detail.

Operations:

1. Plug in, and put through electrical outlet;
2. Open the on-off knob and let the magnifying glass point to the skin which need for checking and operating on;
3. Adjust the distance Cooling Magnifying Lamp head and skin. Also you shall fix the knob. (Annotate: you'd better use some body shaping product on part of body where need examined);
4. End of operation, turn off the on-off knob and close up electrical outlet;

Attentions:

1. If the power electrical wire was damaged, to avoid the danger, please contact with the manufacturer or after-sales services suppliers or other professionals to help you replace it.
2. Do not lay in the place of dank or moisten environment, or else it will bring an electric shock, short circuit and fire etc.
3. Don't take it away when apparatus electrify prevent fire;
4. You must not touch it if dipped by liquid;

● Woods lamp

An advanced way to analyze skin is by using a skin scope. Backed by the technology of facial topography, this skin scope can analyze skin condition and detect and interpret skin problems. It has the ability to identify skin types that co-exists on an individual's face. Skin diseases and problems can be easily detected using a skin scope. Uses black light to illuminate imperfections and dryness in the client's skin. This machine is able to examine skin in minute detail. Indications of Color:

Color and Skin:

1. White with cyan: Healthy skin
2. Yellow with cyan: Greasy skin
3. Purple with cyan: Dry skin
4. Dark purple: Highly dry skin, Dehydrated Skin
5. Orange: Acne greasy skin
6. Light yellow: Acne fester skin
7. Brown and dark brown: Pigmentation skin
8. Purple: Sensitive skin
9. White fluorescence: Thick Corneum Skin

Operation:

1. Please cover eyes with wet cloth patch after skin clean
2. The beautician holds the lamp and let the lamp towards client's face. The distance between face and lamp should be 15cm~20cm, and the mantle should completely cover client's face, make sure no other light disturb.
3. Looking at the color of the skin reflect on the lamp to check skin nature.
4. After finish the checking, please put away the lamp

Caution:

1. Please cover client's eyes with wet cloth patch before start.
2. The testing time should be less than 2 minutes.
3. Please make sure that the distance between face and lamp should be no less than 15cm.
4. The treatment is not suitable for the face with splash.
5. For good effectiveness, please use it in dark room.

● Vacuum and spray

I.Basic principle of vacuum

When air pump working, it can use vacuum to suck out the dirty things in the skin. The air pump make strong air circulation, connect the spray bottle to the vent hole, then can spray cosmetic water. We can adjust the vacuum intensity according to specific situation.

II.Function of vacuum and spray

(1).Remove dirty things in the skin, give the skin a fresh breath. Stimulate the skin organization, strengthen the tenderness of skin.

(2).Accelerate the blood circulation, lead blood to scarfskin, supply nutrition to the skin, promote lymphatic circulation, drain out toxin inside the skin.

(3).The spray function can evenly spray cosmetic water on the skin and make the skin absorb it very well, to help shrink the pore.

III.Main tools

Alcohol cotton, cotton stick, sterile cotton, cosmetic water, vacuum instrument and its accessory

IV.Operation procedure

1. Vacuum

(1). Connect the sterilized glass tube to the pipe

(2) Start the machine and feel the suction intensity on the back o f hand, adjust the intensity according to specific demand.

(3).There are three ways to make vacuum: discontinuous vacuum, continuous vacuum, strong vacuum.

When make treatment to the oily skin, hard and skin, need use much stronger vacuum. When make treatment to xeransis skin, sensitive skin, senile skin, need much lighter vacuum.

● Vacuum and spray

- a. Discontinuous vacuum. During operation, the middle finger should cover and release on the small vent hole of glass tube in a frequent and rhythm way. The vacuum should be not too strong. This kind of operation is better to treat tender skin, loose skin and thin skin.
- b. Continuous vacuum. The middle finger cover the small vent hole of glass tube, and move together with the tube for a while then release the finger. The vacuum need much stronger. This kind of operation is better to treat oily skin, hard and thick skin.
- c. Strong vacuum. The middle finger cover the vent hole of glass tube and don't release, put the tube mouth on the skin, suck and release on the skin frequently. The vacuum intensity need strong. This kind of operation is better to treat oily skin, such parts as nose tip, nose side and the parts with comedones.

2. Spray

Connect the plastic pipe with the spray bottle, use middle finger and thumb to hold the bottle, use first finger to press air hole of the bottle, in this way to form air pressure inside of the bottle and then spray water mist. The beautician hold the spray bottle, spray the client from forehead to face, in this way can avoid water spray into nares.

V. Operation Notice

- (1) Should not move the vacuum tube too slow, should not vacuum at a part for too long time
- (2) According to client's skin nature to adjust the suction intensity, should try it on the hand back at first, then apply to the face part.
- (3) Should match with the steamer to make the treatment.
- (4) Around the eyes, the skin is too thin, should not apply the vacuum.
- (5) Before spray, please ask the client close the eyes, and the spray direction is from forehead to mandible.

● Cold and hot hammer

Cold & Hot Hammer is designed and produced by latest high technology, which accompanied with hairdressing arising in 2000. It is produced on the basis of medical mechanism thus to be reliable and safe. With its functions as cooling, skin-lift, cell-rejuvenation, blood circulation, pain relief, etc., air vibrating can excrete body rubbish and fat. The frequency of 1 million times per second leads to whiten, soft and smooth skin and the slimmer stature.

Cold & Hot Hammer gains recognition of most professionals and it is an available tool for beauticians.

A. Basic face care direction:

The operation order should be from the central part of face to the side, from down to up. Massage method as the picture show:



1. From chin to ears.
2. From chin to nose.
3. From nose to temple.
4. From eye corner to temple with gentle move .Do not apply the treatment around eye area.
5. From the centre of forehead to the side.

B. Basic body care direction:

Move the cold and hot hammer up and down in a helix way.

For the breast care, should make the operation to circle around the breast or to move in the direction of breast muscle. Massage method as the picture show:

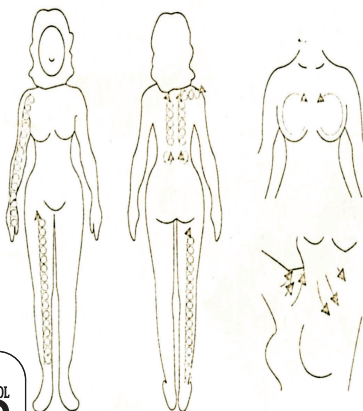

Cold and hot hammer plate :

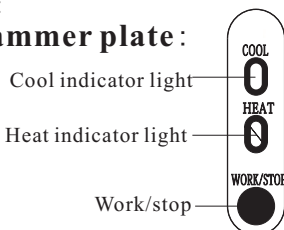

● Skin scrubber

Working principle:

Supersonic skin scrubber is most popular with beauticians among multiple instruments. Trials for long period ensure its outstanding effect on facial care. It shifts electric vibration with 28000 times per second to mechanical vibration with 28000 times per second. Penetration effect of ultrasonic gives skin massage as well as cleansing. Meanwhile deep cells get excited. It can effectively remove spots, wrinkles, pimples, horniness layer and residue in pores so that your skin looks white, purified and elastic.

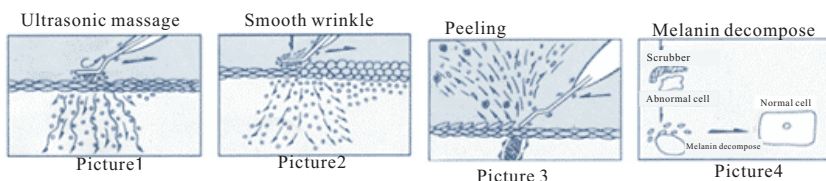

Operation step:

- 1.Put the button A25 to start the scrubber function, and there is a small press-button on the scrubber handle, can press it to make scrubber work.
- 2.Put the button A13 to adjust scrubber intensity(1-9)
- 3.Put the button A14to select scrubber wave mode.
- 4.Clean skin: Make the scrubber be a 45° angle with the skin surface and then move the scrubber towards (follow the picture 3).
- 5.Ultrasonic: Touch the skin parallelly with the scrubber and move it backwards. (follow the picture 1 and 2)

Taboo:

- 1.The person with the pacemakes etc are prohibited to use it.
- 2.The person with the following situation are prohibited to use the machine:
(1). Heart disease (2). Hemophilia(3).Any wound without heal (4). Other serious disease(5). Pregnant women (6)Just did the plastic surgery(7).Just had a baby not for a long time
- 3.The person with the following situation should ask your doctor before using this machine:
(1) Diabetes
(2) Skin with measles
(3) Allergic dermatitis
(4) Asthma

● Skin scrubber

Step for replacing new scrubber:

If the scrubber is broken and need to replace a new one, due to the different frequency of scrubber, should follow the below step to adjust proper frequency for new scrubber.

1.connect on new scrubber

2.power on machine

3.put the button A13  and button A25  at the same time, then the time screen  begin to flash.

4.Put the button A02  to adjust frequency, the value can be from 68 to -8, feel the scrubber intensity and working sound to select the best value.

5.Finished the frequency adjust, put the button A25  to keep the record and exit the frequency adjust for new scrubber.

● Simple failure and solution

| Failure | Solution |
|--|--|
| Power on, the machine is no response | Check whether the power supply is in good connection with main machine |
| | Check whether the power switch is on |
| No output | Check whether the accessory is in good and right connection with the output port of main machine |
| During working, the main machine is overheat | Using for too long time, power off and naturally cool down |
| | Check whether electricity voltage is correct (need professional people to check) |
| No power | Check the fuse, if broken need to replace it |

Technical parameter

Electricity voltage: AC ☐ 110V ☐ 220V ☐ 230V ☐ 240V

Working frequency: ☐ 50Hz ☐ 60Hz

Working frequency: 850W

Packing size(cm): 104x61.5x43cm

● Packing list

| Name | Unit | Q'ty | Actual Q'ty |
|--------------------------|------|------|-------------|
| Mainframe | Pc | 1 | |
| Woods lamp | Pc | 1 | |
| Magnify lamp | Pc | 1 | |
| Mesotherapy probe(face) | Set | 1 | |
| Mesotherapy probe(body) | Pc | 1 | |
| High frequency handle | Pc | 1 | |
| Tongue tube | Pc | 1 | |
| Bend tube | Pc | 1 | |
| Mushroom tube | Pc | 1 | |
| Hand hold galvanic stick | Pc | 1 | |
| Ball galvanic stick | Pc | 1 | |
| Wheel galvanic stick | Pc | 1 | |
| Spot remove handle | Pc | 1 | |
| Cold & hot hammer | Pc | 1 | |
| Spray bottle | Pc | 2 | |
| Round glass sucker | Pc | 1 | |
| Flat glass sucker | Pc | 1 | |
| Gourd glass sucker | Pc | 1 | |
| Dermabrasion accessory | Set | 1 | |
| Ultrasonic eye probe | Pc | 1 | |
| Ultrasonic face probe | Pc | 1 | |
| Scrubber | Pc | 1 | |
| Fuse | Pc | 2 | |
| Power wire | Pc | 1 | |
| Filter mesh | Pc | 20 | |
| Seal ring | Pc | 10 | |
| Red and black hose | Pc | 2 | |
| woods lamp bag | Pc | 1 | |
| Shelf | Pc | 3 | |
| Spanner | Pc | 1 | |
| Instruction | Pc | 1 | |

● Safety notice

1. Please don't disassemble the equipment or try to do some other operation, which have been indicated in our instruction. All the repairing work should be done by our admitted professional personnel.
2. Please don't assemble or operate this equipment while you are near the water or your hands are wet. Notice that don't pour the liquid on it.
3. Please pull out the plug from the socket when you met such conditions as below. And keep in touch with professional maintenance Station.
 - A. The equipment touched liquid
 - B. The equipment has abnormal smell, smoking or loud and strong noise.
 - C. Cable is broken
 - D. The equipment is fallen down and broken
4. Please don't put anything on the cables, don't place the equipment at any place where someone can step on the cable.
5. Please pull out the power cable after using it for your safety.
6. Don't put anything into the equipment's jack, otherwise it may cause fire or touch the electricity. If something enters the equipment, please don't pick it out by yourself, contract distributor or our company immediately.
7. Please don't put the equipment on the anything that can't stand steadily, avoid it turns over and damage.
9. Our company reserves the right to modify the information in this introduction before notify! And keep the explanations right for the above..

Attention:

If the supply cord is damaged, it must be replaced by manufacturer, its service agent or similarly qualified persons in order to avoid a hazard. This appliance is not intended for use by persons (including children) with reduced physical, sensory or mental capabilities, or lack of experience and knowledge, unless they have been given supervision or instruction concerning use of the appliance by a person responsible for their safety. Children should be supervised to ensure that they do not play with the